

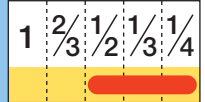

**For Security
Fish-Eye**

FE185C046HA-1

Applicable camera (model)



FISH-EYE LENSES



*Photograph is a similar model.

- High-resolution design, providing support for up to 5 megapixel camera resolution.
- Super wide angle of 185 degrees that eliminates dead angles and enables effective, wide-area surveillance.
- Designed with the f-theta system, most suited for uniform displaying of images. Allows high-quality image display, partial enlargement, and conversion to ordinary-looking images to be performed easily with imaging software.

FIXED
Fixed Focal

Fish-Eye 185°
Fish-Eye

5 Mega
For Megapixel Camera

MANUAL
Manual Iris

C-mt
C Mount

METAL
Metal Mount

F1.4
Wide Aperture Rate

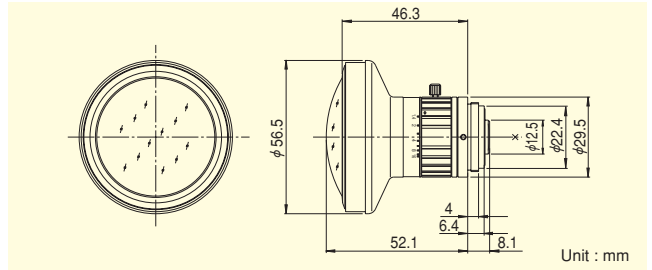

Unit : mm

Focal Length (mm)		1.4
Iris Range		F1.4 ~ F16
Operation	Focus	Fixed
	Iris	Manual
Angle Of View (H×V)	1/2"	185° × 185° (φ4.6mm)
	1/3"	185° × 144° 47'
	1/4"	144° 47' × 108° 35'
Focusing Range (From Front Of The Lens) (m)		∞ ~ 0.1
Back Focal Distance (in air) (mm)		9.70
Exit Pupil Position (From Image Plane) (mm)		-61
Filter Thread (mm)		—
Mount		C
Mass (g)		140
Remarks	<ul style="list-style-type: none"> •With Metal Mount •With Locking Knob for Iris 	

[Fish-Eye Lens Image]



**For Security
Fish-Eye**

FE185C057HA-1

Applicable camera (model)

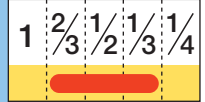

*Photograph is a similar model.

- High-resolution design, providing support for up to 5 megapixel camera resolution.
- Super wide angle of 185 degrees that eliminates dead angles and enables effective, wide-area surveillance.
- Designed with the f-theta system, most suited for uniform displaying of images. Allows high-quality image display, partial enlargement, and conversion to ordinary-looking images to be performed easily with imaging software.

FIXED
Fixed Focal

Fish-Eye 185°
Fish-Eye

5 Mega
For Megapixel Camera

MANUAL
Manual Iris

C-mt
C Mount

METAL
Metal Mount

F1.4
Wide Aperture Rate

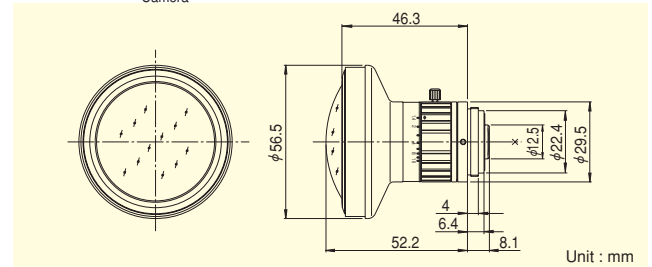

Unit : mm

Focal Length (mm)		1.8
Iris Range		F1.4 ~ F16
Operation	Focus	Fixed
	Iris	Manual
Angle Of View (H×V)	2/3"	185° × 185° (φ5.7mm)
	1/2"	185° 01' × 154° 08'
	1/3"	154° 08' × 115° 27'
Focusing Range (From Front Of The Lens) (m)		∞ ~ 0.1
Back Focal Distance (in air) (mm)		9.70
Exit Pupil Position (From Image Plane) (mm)		-61
Filter Thread (mm)		—
Mount		C
Mass (g)		135
Remarks	<ul style="list-style-type: none"> •With Metal Mount •With Locking Knob for Iris 	

[Fish-Eye Lens Image]

